

Dropped Sling to Drill Floor

Description of Incident (March 29, 2025)

During preparations for scaffold construction on the monkey board, workers used two slings in a choke configuration to bundle scaffold materials on the drill floor for transport. The bundled load was hoisted to the monkey board using the winch line. Once the load was landed, the south winch line was secured, and the slings were disconnected from the winch line hook. The slings remained choked around the scaffold bundle to allow for the staged removal of scaffold materials by the scaffold team. A trained rigger was present for the duration of the task.

After all materials were staged, the spotter on the drill floor notified the crew on monkey board via radio that one of the slings had fallen to the drill floor. The dropped object was a ½" diameter by 15-foot-long wire type sling weighing approximately 10lbs and it originated from approximate height of 85 feet directly above its final resting place. Pre-job planning identified working at height hazards with exclusion zones established and communicated. No personnel entered the exclusion zone at the time of the drop due to proper exclusion zone enforcement.

What Went Wrong

- The slings were choked around the scaffold materials but not secured. This did not pose an immediate hazard, however, once all scaffold components had been removed, the unsecured slings were not identified as a dropped object hazard.
- Work Package Needs Improvement (Work Safe Procedure) - when scaffold is landed on the monkey board level, the slings around the scaffolding should be loosened (to allow the scaffold to be removed) and remain hooked up to the winch line hook.

Corrective Actions & Recommendations

The following corrective action was recommended and implemented:

- Ensure work instructions capture the requirement for slings removed from scaffold bundles to be either secured at the worksite or returned to the winch line hook for transport back to the rig floor.

The operator recommends readers consider the following learning questions for error prone situations:

- Have you identified all Life Saving Rules and Actions and potential hazards or only the obvious ones?
- How can your work environment or procedure be improved to make the task easier to get right, harder to get wrong?

Applicable Lifesaving Rule

IOGP's [Line of Fire](#) lifesaving rule is applicable to this incident.

Posted on June 27, 2025.

[Read more](#) Atlantic Canada Offshore Safety Alerts.

Related Images

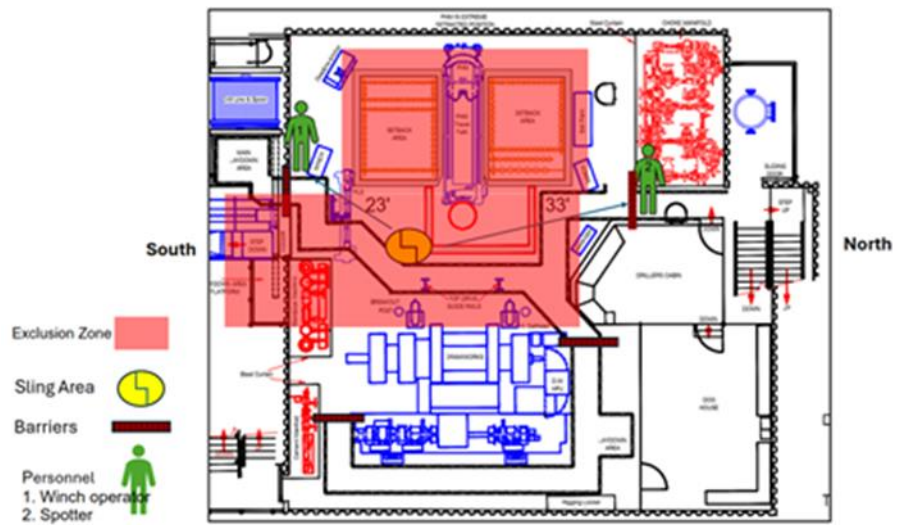

Figure 1: Red Zone Diagram with Dropped Object and Personnel